

GS/G RA 25S2 800X525

Galvanised hand pallet truck (2.500 kg)



MR HYDRO

Mr. Hydro series, which is available in numerous versions, is the ideal tool to handle loads in humid and damp conditions. In particular the "inox" version is suitable for environments where high hygienic standards are enforced, such as the chemical, pharmaceutical or food & beverage industry.



2500 kg



200 mm

GS/G

The galvanised pallet truck offers good resistance to corrosion thanks to the hot dip galvanizing process of the frame and the handle.



ANTI RUST COATING HYDRAULIC PUMP

Resistant and reliable one piece cast iron pump with GEOMET® surface coating treatment to prevent rust pitting and corrosion damages.

Worked with numerical control machine, it includes:

- MAXIMUM PRESSURE VALVE: safety device that ensures the transpallet against overloads. When the pressure inside the hydraulic circuit exceeds the calibration value according to the maximum nominal flow, the valve automatically locks the forks.
- PROPORTIONAL LOWERING VALVE: lowering speed can be proportionally controlled according to the lever position on the tiller. Perfect working tool to carry fragile and delicate loads like crystal, glass and ceramics.

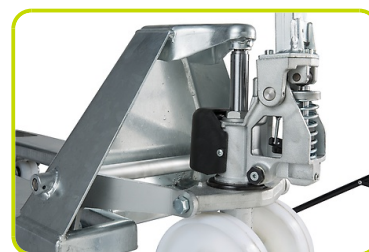

STANDARD CONFIGURATION

- Nylon steering wheels
- Nylon rollers
- 2 Curves handle with all the controls (lowering / drive position / lifting) available in a single lever for simple and safe control
- Entry/exit rollers. Supplementary rollers allow easier entrance and quicker exit from a closed pallet, reducing the impact on main rollers and guaranteeing longer life



Descrição

1.1 Fabricante			LIFTER
1.3 Acionamento			Manual
1.4 Tipo de Operador			Pedestre
1.5 Capacidade de carga	Q	Kg	2500
1.6 Centro de distância de carga	c	mm	400
1.8 Carga do eixo ao final dos garfos	x	mm	582
1.9 Base de roda	y	mm	842

Peso

2.1 Peso de Serviço		Kg	55
2.2 Carga do Eixo - Frente Próxima		Kg	1791
2.2 Carga do eixo - frente carregada		Kg	764
2.3 Carga do eixo - frente vazia		Kg	16
2.3 Carga do eixo - frente vazia		Kg	39

Estrutura/Rodas

3.1 Koła sterujące			NYLON
3.1 Rodas: Rolos de carga			NYLON
3.2 Tamanho do Pneu: Volantes - Diâmetro		mm	200
3.2 Tamanho do pneu: Volantes - Largura		mm	50
3.3 Tamanho do pneu: Rolos de carga - Diâmetro		mm	82
3.3 Tamanho do Pneu: Rolos de Carga - Largura		mm	82
3.5 Dimensão dos pneus: rodas traseiras - Qtd. (X=livre)		nr	2
3.5 Eixo Traseiro de Equilíbrio			No
3.6 Piso da Frente	b10	mm	155
3.7 Traseira do Piso	b11	mm	375

Dimensões

4.4 Altura da Elevação	h3	mm	115
4.9 Altura Maxima em Posição de Movimento	h14	mm	1160
4.15 Altura, Baixo	h13	mm	85
4.19 Comprimento Total	l1	mm	1200
4.20 Comprimento dos Garfos	l2	mm	400
4.21 Largura Total	b1	mm	525
4.22 Garfos - Espessuras	s	mm	55
4.22 Garfos - Largura	e	mm	150
4.22 Garfos - Comprimentos	l	mm	800
4.25 Distância Entre Garfos	b5	mm	525
4.32 Ao Solo, Centro de Distância Entre os Eixos	m2	mm	30
4.34 Largura do Corredor	Ast	mm	1435
4.35 Raio do Ângulo	Wa	mm	1017

Desempenho

5.2 Velocidade de Elevação Carregado	strokes		13
5.2 Velocidade de Elevação Descarregado	strokes		13

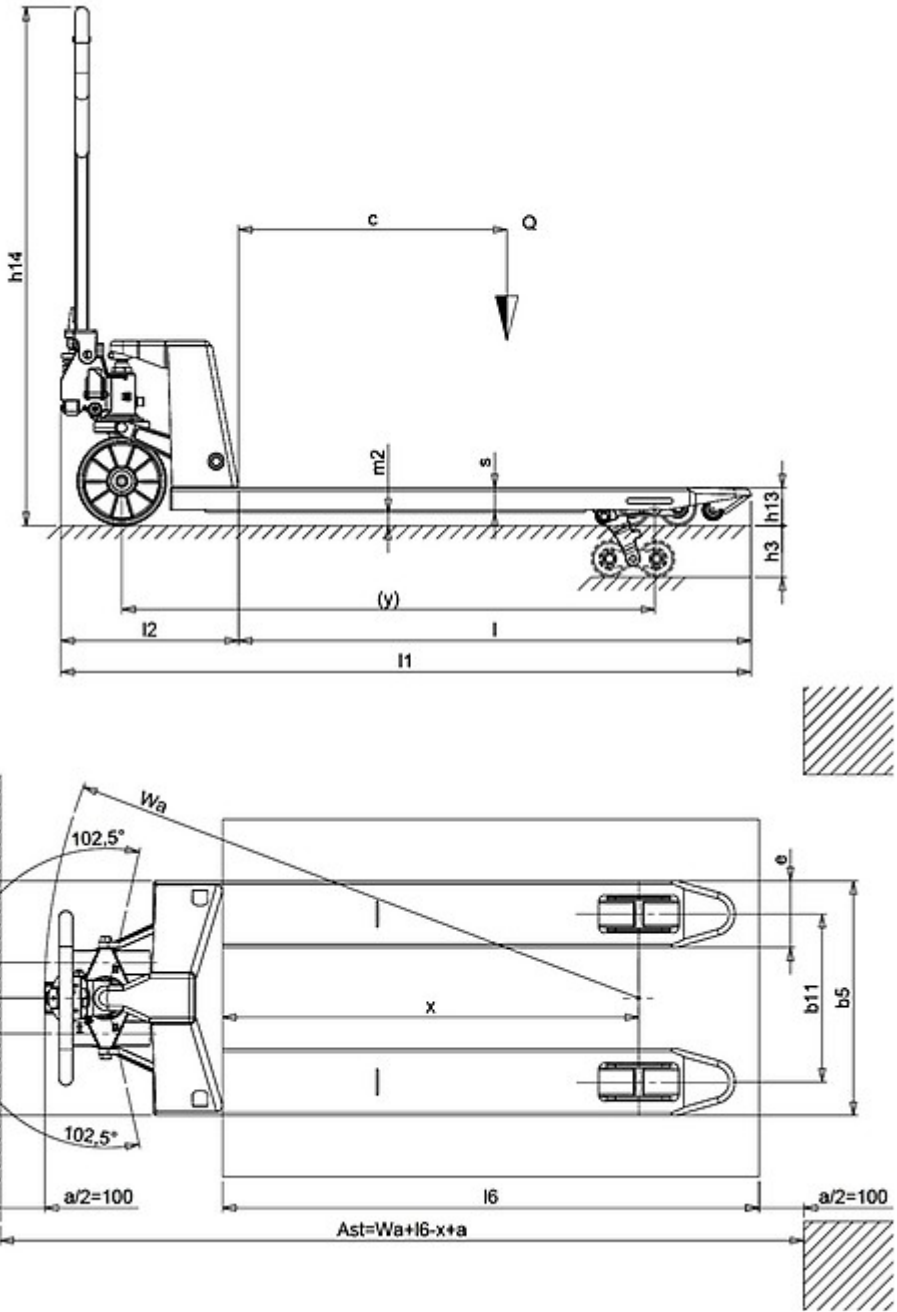

The information is aligned with the Data file at the time of download. Printed on 08/06/2020 (ID 592)

©2019 | PR INDUSTRIAL s.r.l. | All rights reserved | Image shown may not reflect actual package. Specifications subject to change without notice

