

# GS/P AGILE PLUS S4 1185X555

## THE AGILE SCALE PALLET TRUCK



### GS/P Agile plus

Agile motorized pallet truck with weight indicator combines electric and manual function for convenient usability. Compact, light, simple and easy to use, it also provides an accurate estimate of the weight of the load during the material handling process without delaying the handling of the goods. The machine can be equipped with supplements such as printer or USB, and thanks to the 4 load cells it is able to be very precise and functional; ideal for checking incoming goods, avoiding overloads and determining shipping weights.



### SCALE TRUCK GS/P

The GS/P pallet truck is an intelligent and robust tool to be used for weighing and transporting your loads at the same time, making stock and dispatch processes faster, simpler and more efficient. The machine can be equipped with supplements such as printer or SD memory card and thanks to the 4 load cells it is able to be very precise and functional; ideal for checking incoming goods, avoiding overloads and determining shipping weights.



### DISPLAY

Its large-sized 6 digits LCD display provides accurate and precise weighing in kg and lb. Its software allows not only net/gross/tare weighing but also unit counting, adding and totalling of multiple loads. Weights are shown in 1 kg/lb steps with 0,05% precision.



## FRAME STRUCTURE

The structure is designed with a double frame consisting of a lower fork on which stands a counter fork. Both forks house two load cells allowing a uniform load distribution, and keeping high weighing accuracy even in case of collision and unbalanced load.



## BATTERY and BATTERY CHARGER

The GS/P is supplied complete with rechargeable battery and charger. The battery module provides 50 hours autonomy.



## PRINTER / USB

*(Supplement , only available at time of order)*

As supplement, the machine can be equipped with a built-in printer, able to print gross, tare and net weights (kg or lb), date, quantity of pieces on the scale.

It may also be enriched with another supplement, the USB, allowing you to store weighing data in a text file, for archiving and processing via PC.



## AGILE PLUS

The AGILE PLUS is equipped with a Li-ION powerful BATTERY 36V 12,8Ah and the ON BOARD COMPUTER with OLED display that supplies operator several information and the possibility to regulate the maximum travelling speed from 3,2 to 5,3 Km/h, adapting thus the operator experience to the specific application.



## DOUBLE TRACTION WHEEL

The first pallet truck with two traction/steering wheels in the market. The big diameter (200mm) and tread (160mm) provide great stability without the needs of stabilizers. Non-marking rubbers grant great traction and comfortable usage on all applications.



## LI-ION BATTERY

Long life 36V battery easy to remove for charging and continuous operation with the spare battery.

Two types of charger available (bench and wall mounted) with standard and fast charging time.



## HIGH SPEED

The two motorwheels grant high performances and make the AGILE the fastest of the category. The AC technology and the soft non-marking rubbers make the AGILE an extremely quiet unit.



## ELECTRIC / MANUAL SWITCH

The AGILE is equipped with a MANUAL SWITCH that can be used in the eventual case of low battery; electro brakes are released and the small friction created makes the AGILE as reliable as a standard pallet truck.

On order to move the unit in narrow space AGILE is equipped with TURTLE SWITCH to allow for operation with the tiller in vertical position on reduced speed.



## ON-BOARD COMPUTER

Front OLED display with 6 selectable screens provides valuable info on truck activity and allows performance setup:

Pressing the central SCROLL button, operator can get information on:

- Battery status of charge (% of charge)
- Timers (total and partial in h)
- Odometer (total and partial in km)
- Speed setting (% of max speed)
- Diagnostic
- Error page



## OPTIONS

- Quicklift hydraulic pump to lift the pallet in just two strokes
- Additional battery for continuous use
- Fast charging battery charger



## Descrição

1.1 Fabricante			LIFTER
1.3 Acionamento			Elétrico
1.4 Tipo de Operador			Pedestre
1.5 Capacidade de carga	Q	Kg	1200
1.6 Centro de distância de carga	c	mm	600
1.8 Carga do eixo ao final dos garfos	x	mm	975,5
1.9 Base de roda	y	mm	1250

## Peso

2.1 Peso de Serviço (Bateria Incluída)		Kg	128
2.2 Carga do Eixo - Frente Próxima		Kg	884
2.2 Carga do eixo - frente carregada		Kg	444
2.3 Carga do eixo - frente vazia		Kg	83
2.3 Carga do eixo - frente vazia		Kg	45

## Estrutura/Rodas

3.1 Koła sterujące			BORRACHA
3.1 Rodas: Rolos de carga			POLY
3.2 Tamanho do pneu: Volantes - Largura		mm	40
3.2 Tamanho do Pneu: Volantes - Diâmetro		mm	200
3.3 Tamanho do pneu: Rolos de carga - Diâmetro		mm	82
3.3 Tamanho do Pneu: Rolos de Carga - Largura		mm	60
3.5 Dimensão dos pneus: rodas traseiras - Qtd. (X=livre)		nr	4
3.5 Dimensão dos pneus: rodas dianteiras - Qtd. (X=livre)		nr	2x
3.5 Eixo Traseiro de Equilíbrio			No
3.6 Piso da Frente		b10 mm	162
3.7 Traseira do Piso		b11 mm	375

## Dimensões

4.4 Altura da Elevação		h3 mm	115
4.9 Height of tiller in drive position min		h14 mm	710
4.9 Altura Maxima em Posição de Movimento		h14 mm	1185
4.15 Altura, Baixo		h13 mm	90
4.19 Comprimento Total		l1 mm	1660
4.20 Comprimento dos Garfos		l2 mm	473
4.21 Largura Total		b1 mm	555
4.22 Garfos - Espessuras		s mm	60
4.22 Garfos - Largura		e mm	180
4.22 Garfos - Comprimentos		l mm	1185
4.25 Distância Entre Garfos		b5 mm	555
4.32 Ao Solo, Centro de Distância Entre os Eixos		m2 mm	30
4.34 Largura do Corredor		Ast mm	2109
4.35 Raio do Ângulo		Wa mm	1450

### Desempenho

5.1 Velocidade da Viagem Carregado	Km/h	4,2
5.1 Velocidade da Viagem Descarregado	Km/h	5,3
5.2 Velocidade de Elevação Carregado	strokes	12
5.2 Velocidade de Elevação Descarregado	strokes	12

### Motores Elétrico

6.1 Unidade de Potência do Motor	kW	2x0,25
6.4 Voltagem da bateria	V	36
6.5 Peso Maximo da Bateria	Kg	3

### Balança

Digitos	Q.ty	6
Digitos de Altura	mm	25
Quilogramas		Yes
Lbs		Yes
Tara		Yes
Desligamento Automático		Yes
Totalização		Yes
Contador		Yes
Tempo de Operação	h	50
Precisão	%	0.05
Células de carga tipo shear-bean	Q.ty	4
Divisão	Kg	0.5
6.4 Voltagem da bateria	V	6
6.4 Capacidade da Bateria	Ah	4

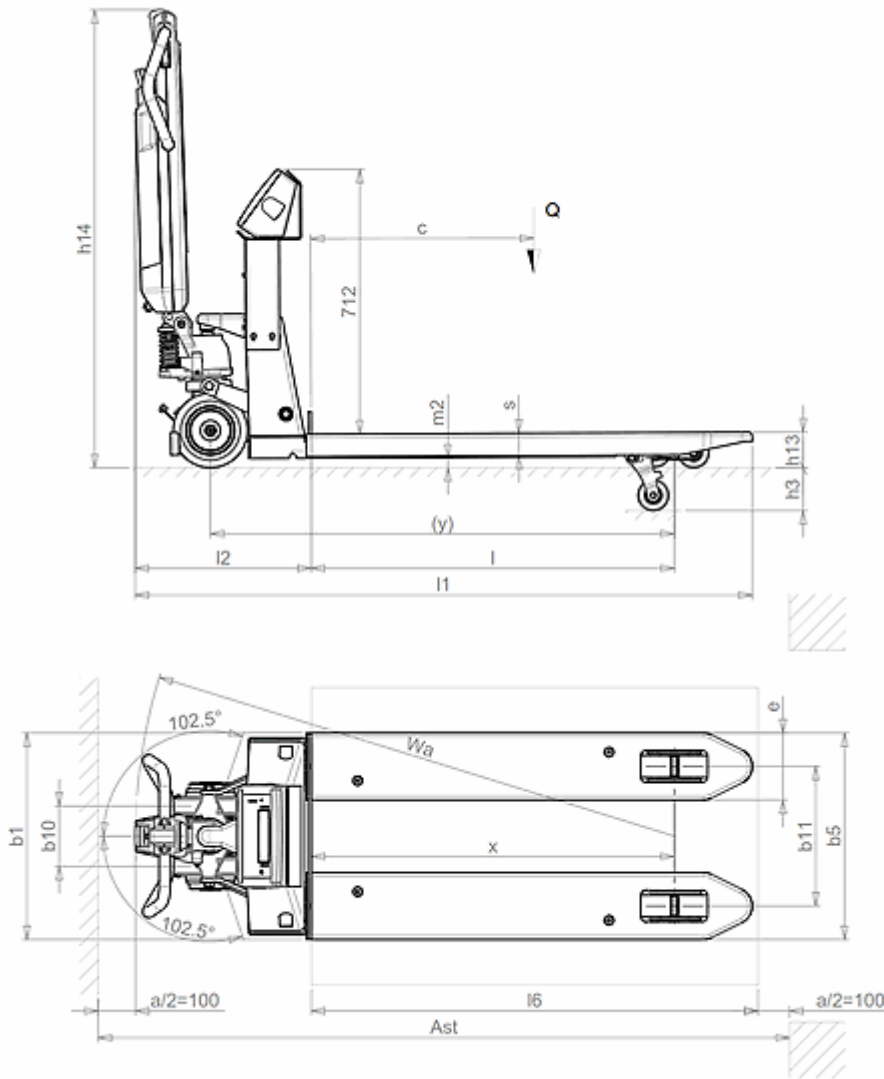

The information is aligned with the Data file at the time of download. Printed on 09/06/2020 (ID 11905)

©2019 | PR INDUSTRIAL s.r.l. | All rights reserved | Image shown may not reflect actual package. Specifications subject to change without notice

